

# 50.0MM (K TYPE)

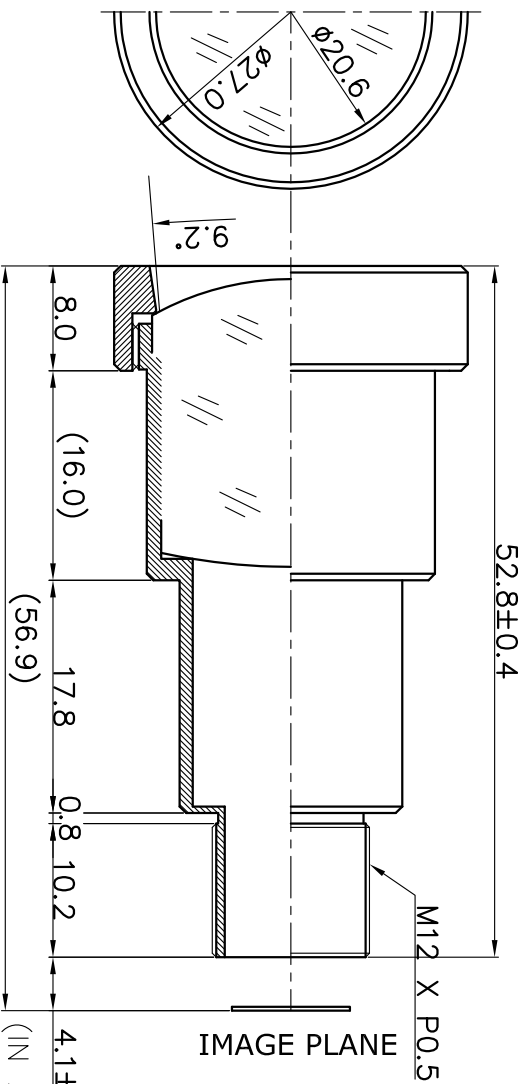

1. SENSING AREA : 1/2" & 1/3" CCD
  2. FOCAL LENGTH : 50.0MM ± 5%
  3. BACK FOCAL LENGTH : 33.9MM ± 5% (IN AIR)
  4. MAXIMUM RELATIVE APERTURE : 2.0± 5%
  5. IRIS : FIXED
  6. LENS CONSTRUCTION : 4COMPONENTS 4ELEMENTS
  7. ANGULAR FIELD OF VIEW : 1/2" & 1/3"  
 DIAGONAL 9.2° & 6.8°  
 HORIZONTAL 6.8° 5.1°  
 VERTICAL 5.0° 3.7°
  8. MINIMUM OBJECT DISTANCE : 40 CM -00
  9. WEIGHT : 27.1gr
- ( IT IS CHANGEABLE ON EXTERNAL DIMENSION BY  
 BY CUSTOMER'S REQUIREMENT.)

E-mail : hki9612@hkopto.com  
 Website : http://hkopto.com

		TOLERANCES		Designed	BANG HYE SUN	Title	FOR B/W & COLOR f=50.0MM Fno 2.5
		ANGLE 1°/2	Checked	PARK JIN HYUN			
A4	Scale	N/S	X. ± 0.2	Approved		DATE	2019.01.07
			.X ± 0.1			REVISION NO.	-00
			.XX ± 0.05	Dwg No.	HK-V5004S		